

Transient Voltage Suppressors for ESD Protection

Low Capacitance

ESDXXV23T-LA Series

Description

The ESDXXV23T-LA is designed to protect voltage sensitive components from ESD and transient voltage events. Excellent clamping capability, low leakage, and fast response time, make these parts ideal for ESD protection on designs where board space is at a premium.

Feature

- ◆ 300 Watts Peak Pulse Power per Line (tp=8/20µs)
- ◆ Protects two I/O lines (Common Mode)
- ◆ Protects one I/O line (Differential Mode)
- ◆ Working voltages : 3.3, 5, 8, 12, 15 and 24V
- ◆ Low leakage current
- ◆ Low clamping voltage
- ◆ IEC61000-4-2 (ESD) ±15kV (air), ±8kV (contact)
- ◆ IEC61000-4-4 (EFT) 40A (5/50 ns)
- ◆ IEC61000-4-5 (Lightning) 5A (8/20µs)

Applications

- ◆ Digital Visual Interface (DVI)
- ◆ Audio/Video Inputs
- ◆ Wireless Network Systems
- ◆ Monitors and Flat Panel Displays
- ◆ Medical Sensors
- ◆ Notebook Computers
- ◆ Set Top Box
- ◆ Projection TV

SOT-23



Functional Diagram

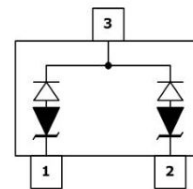

Mechanical Data

- ◆ JEDEC SOT-23 Package
- ◆ Molding Compound Flammability Rating : UL 94V-0
- ◆ Weight 8 Milligrams (Approximate)
- ◆ Quantity Per Reel : 3,000pcs
- ◆ Reel Size : 7 inch
- ◆ Lead Finish : Lead Free

Mechanical Characteristics

Symbol	Parameter	Value	Units
Ppp	Peak Pulse Power (tp=8/20µs waveform) -- ESD05V32D-LA	300	Watts
T _J	Operating Junction Temperature Range	-55 to +150	°C
T _{STG}	Storage Temperature Range	-55 to +150	°C
T _L	Soldering Temperature	260	°C

Transient Voltage Suppressors for ESD Protection

Low Capacitance

ESDXXV23T-LA Series

Electrical Characteristics (@ 25°C Unless Otherwise Specified)

Part Number	Device Marking Code	Stand-Off Voltage V_{RWM} (V)	Breakdown Voltage V_{BR}	Test Current I_T (mA)	V_C @1A (Max.)	V_C		Maximum Reverse Leakage I_R @ V_{RWM} (uA)	Maximum Junction Capacitance @0 V (pF)
						(Max.)	(@A)		
ESD03V23T-LA	N03	3.3	4.0	1.0	7.5	21	15	40	0.6
ESD05V23T-LA	N05	5.0	6.0	1.0	9.8	25	14	1	0.6
ESD08V23T-LA	N08	8.0	8.5	1.0	13.4	26	11	1	0.6
ESD12V23T-LA	N12	12	13.3	1.0	19.0	30	6	1	0.6
ESD15V23T-LA	N15	15	16.7	1.0	24.0	35	5	1	0.6
ESD24V23T-LA	N24	24	26.7	1.0	43.0	56	3	1	0.6

Fig1. 8/20µs Pulse Waveform

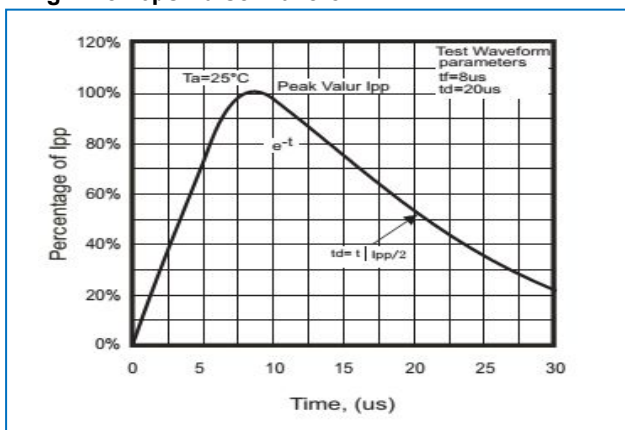

Fig2.ESD Pulse Waveform (according to IEC 61000-4-2)

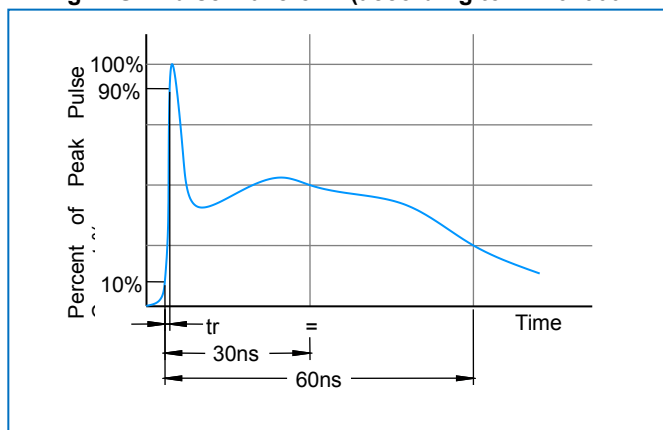

Fig3. ESD Clamping Voltage Screenshot Positive 8 KV contact per IEC 61000-4-2

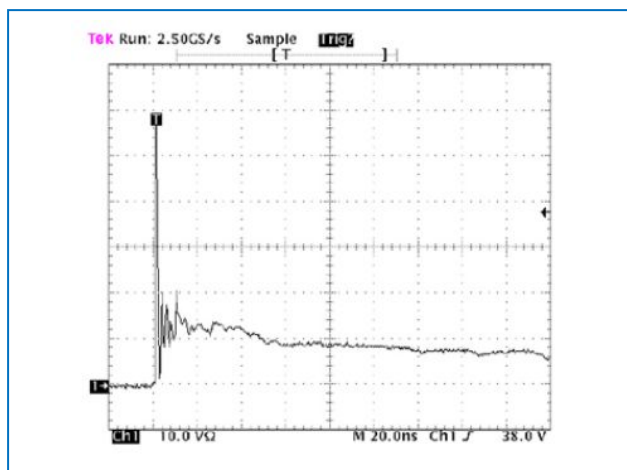
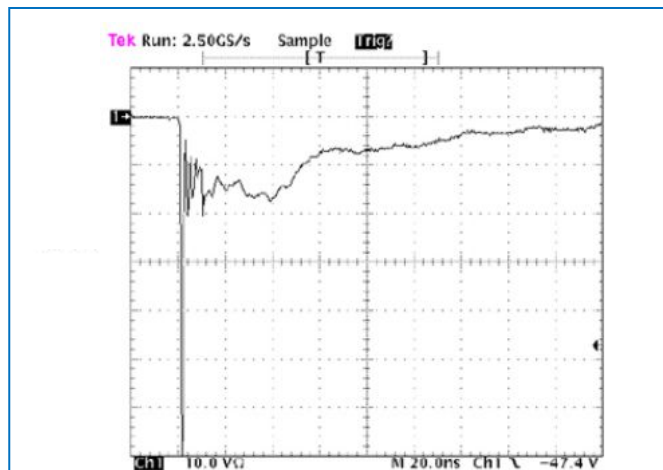

Fig4. ESD Clamping Voltage Screenshot Negative 8 KV contact per IEC 61000-4-2



Transient Voltage Suppressors for ESD Protection

Low Capacitance

ESDXXV23T-LA Series

SOT-23 Package Outline & Dimensions

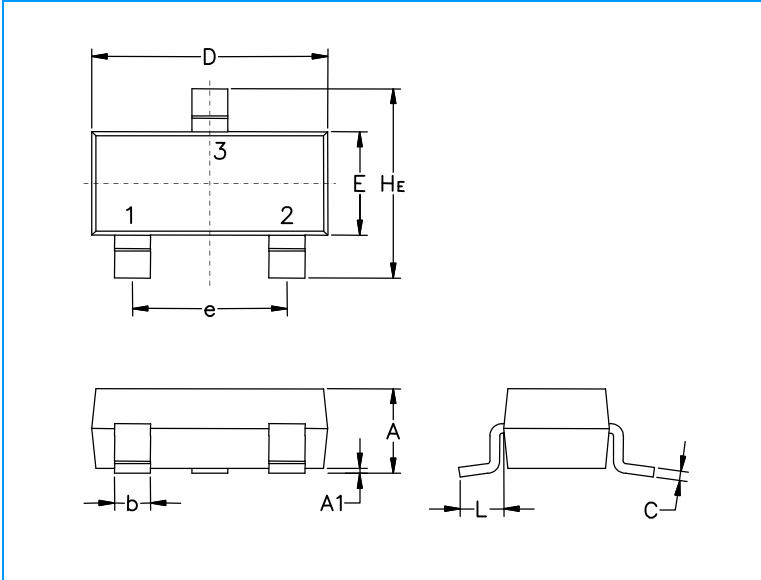

Symbol	Millimeters			Inches		
	Min.	Nom.	Max.	Min.	Nom.	Max.
A	0.89	1.00	1.11	0.035	0.040	0.044
A1	0.01	0.06	0.10	0.001	0.002	0.004
b	0.37	0.44	0.50	0.15	0.18	0.020
c	0.09	0.13	0.18	0.003	0.005	0.007
D	2.80	2.90	3.04	0.110	0.114	0.120
E	1.20	1.30	1.40	0.047	0.051	0.055
e	1.78	1.90	2.04	0.070	0.075	0.081
L	0.35	0.54	0.69	0.014	0.021	0.029
HE	2.10	2.40	2.64	0.083	0.094	0.104

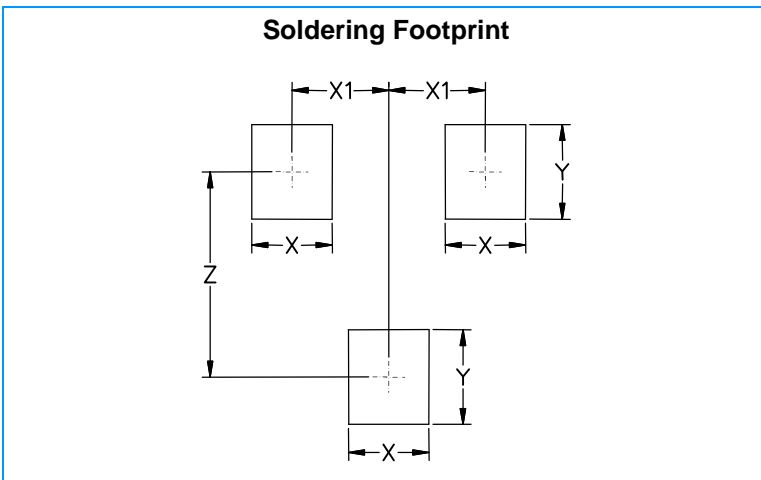

Symbol	Millimeters	Inches
X	0.80	0.031
X1	0.95	0.037
Y	0.90	0.035
Z	2.00	0.079